

B1

INTRACOASTAL
BAY VIEW

TWO BEDROOMS
TWO BATHS

INTERIOR 1,069 SF | 99.3 SM
EXTERIOR 654 SF | 60.8 SM
TOTAL 1,723 SF | 160.1 SM



This is not intended to be an offer to sell, or solicitation to buy, condominium units to residents of any jurisdiction where prohibited by law, and your eligibility for purchase will depend upon your state of residency. The offering is made only by the prospectus for the condominium and no statement should be relied upon if not made in the prospectus. Stated interior square footage is measured to the exterior face of exterior walls and to the centerline of interior dividing walls or to the exterior face of walls adjoining corridors or other common elements or shared facilities without reducing areas that may be occupied by columns or other structural components. This method of measurement varies from and is larger than the dimensions that would be determined by using the description and the definition of the Unit set forth in the Declaration (which generally only includes the interior airspace between the perimeter walls and excludes structural components). For reference, the area of the unit, determined in accordance with the unit boundaries set forth in the Declaration is set forth in Exhibit "D" to the Declaration. All dimensions are approximate and may vary with actual construction. **ORAL REPRESENTATIONS CANNOT BE RELIED UPON AS CORRECTLY STATING THE REPRESENTATIONS OF THE DEVELOPER. FOR CORRECT REPRESENTATIONS, MAKE REFERENCE TO THE BROCHURE AND TO THE DOCUMENTS REQUIRED BY SECTION 718.503, FLORIDA STATUTES, TO BE FURNISHED BY A DEVELOPER TO A BUYER OR LESSEE.**

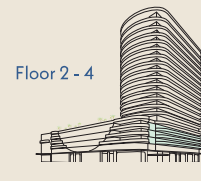

B3

TWO BEDROOMS
TWO BATHS
ONE POWDER ROOM

INTERIOR 1,200 SF | 111.5 SM
EXTERIOR 669 SF | 62.2 SM
TOTAL 1,869 SF | 173.6 SM

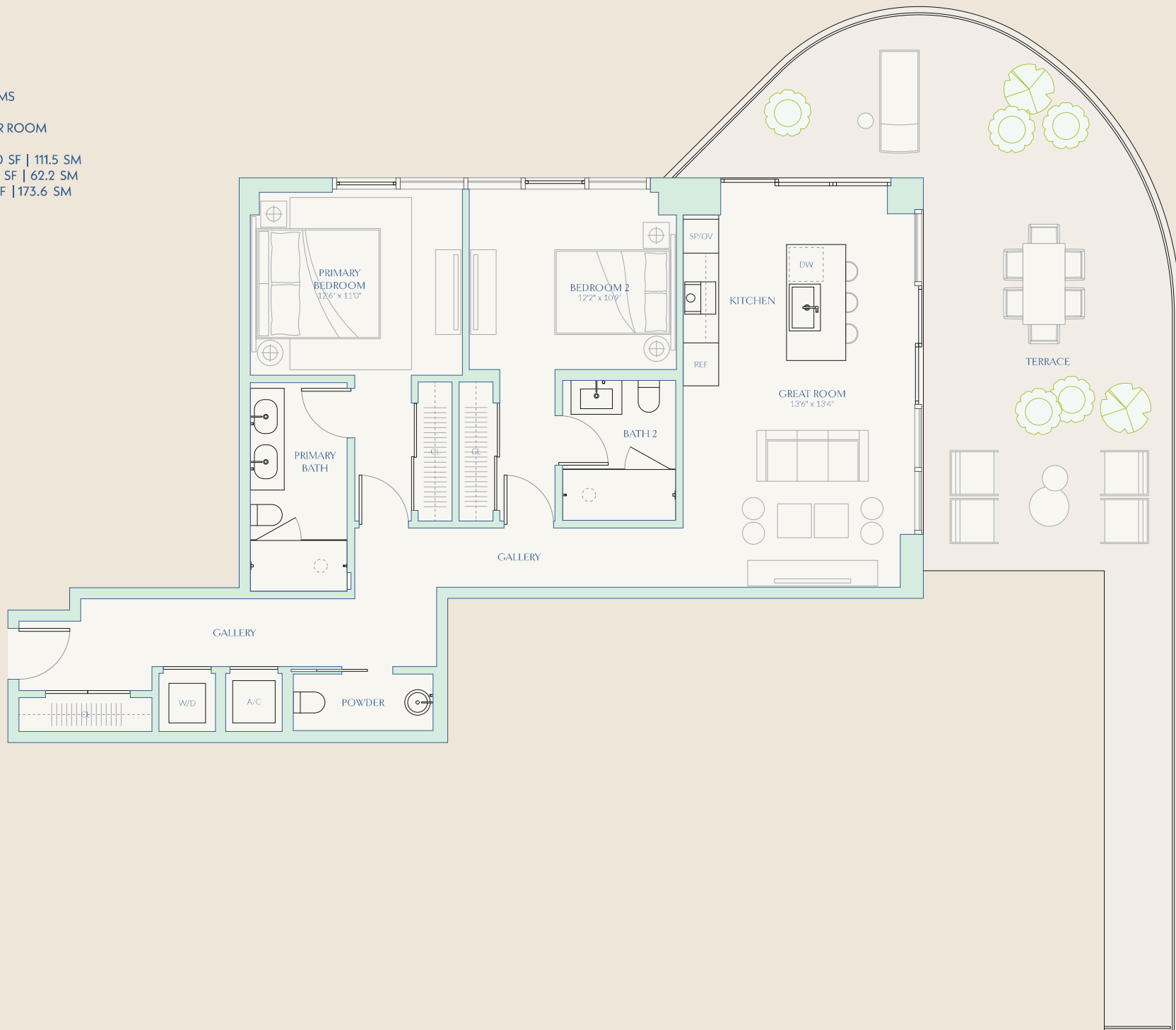

This is not intended to be an offer to sell, or solicitation to buy, condominium units to residents of any jurisdiction where prohibited by law, and your eligibility for purchase will depend upon your state of residency. The offering is made only by the prospectus for the condominium and no statement should be relied upon if not made in the prospectus. Stated interior square footage is measured to the exterior face of exterior walls and to the centerline of interior dividing walls or to the exterior face of walls adjoining corridors or other common elements or shared facilities without including areas that may be occupied by columns or other structural components. This method of measurement varies from, and is larger than, the dimensions that would be determined by using the description and the definition of the Unit set forth in the Declaration (which generally only includes the interior airspace between the perimeter walls and excludes structural components). For reference, the area of the unit, determined in accordance with the unit boundaries set forth in Exhibit "D" to the Declaration, all dimensions are approximate and may vary with actual construction. **ORAL REPRESENTATIONS CANNOT BE RELIED UPON AS CORRECTLY STATING THE REPRESENTATIONS OF THE DEVELOPER. FOR CORRECT REPRESENTATIONS, MAKE REFERENCE TO THIS BROCHURE AND TO THE DOCUMENTS REQUIRED BY SECTION 718.503, FLORIDA STATUTES, TO BE FURNISHED BY A DEVELOPER TO A BUYER OR LESSEE.**

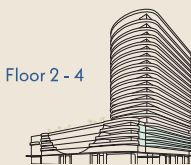

B4

TWO BEDROOMS
TWO BATHS
ONE POWDER ROOM

INTERIOR 1,403 SF | 130.3 SM
EXTERIOR 698 SF | 64.8 SM
TOTAL 2,101 SF | 195.2 SM



INTRACOASTAL/
BAYVIEW



This is not intended to be an offer to sell, or solicitation to buy, condominium units to residents of any jurisdiction where prohibited by law, and your eligibility for purchase will depend upon your state of residency. The offering is made only by the prospectus for the condominium and no statement should be relied upon if not made in the prospectus. Stated interior square footage is measured to the exterior face of exterior walls and to the centerline of interior dividing walls or to the exterior face of walls adjoining corridors or other common elements or shared facilities without including areas that may be occupied by columns or other structural components. This method of measurement varies from and is larger than the dimensions that would be determined by using the description and the definition of the Unit set forth in the Declaration which generally only includes the interior airspace between the perimeter walls and excludes structural components. For reference, the area of the unit, determined in accordance with the unit boundaries set forth in the Declaration is set forth in Exhibit "D" to the Declaration. All dimensions are approximate and may vary with actual construction. **ORAL REPRESENTATIONS CANNOT BE RELIED UPON AS CORRECTLY STATING THE REPRESENTATIONS OF THE DEVELOPER. FOR CORRECT REPRESENTATIONS, MAKE REFERENCE TO THE BROCHURE AND TO THE DOCUMENTS REQUIRED BY SECTION 718.503, FLORIDA STATUTES, TO BE FURNISHED BY A DEVELOPER TO A BUYER OR LESSEE.**

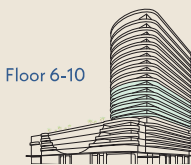

B5

PARK &
 OCEAN VIEW

TWO BEDROOMS
 TWO BATHS
 ONE POWDER ROOM

INTERIOR 1,268 SF | 117.8 SM
 EXTERIOR 597 SF | 55.5 SM
 TOTAL 1,865 SF | 173.3 SM

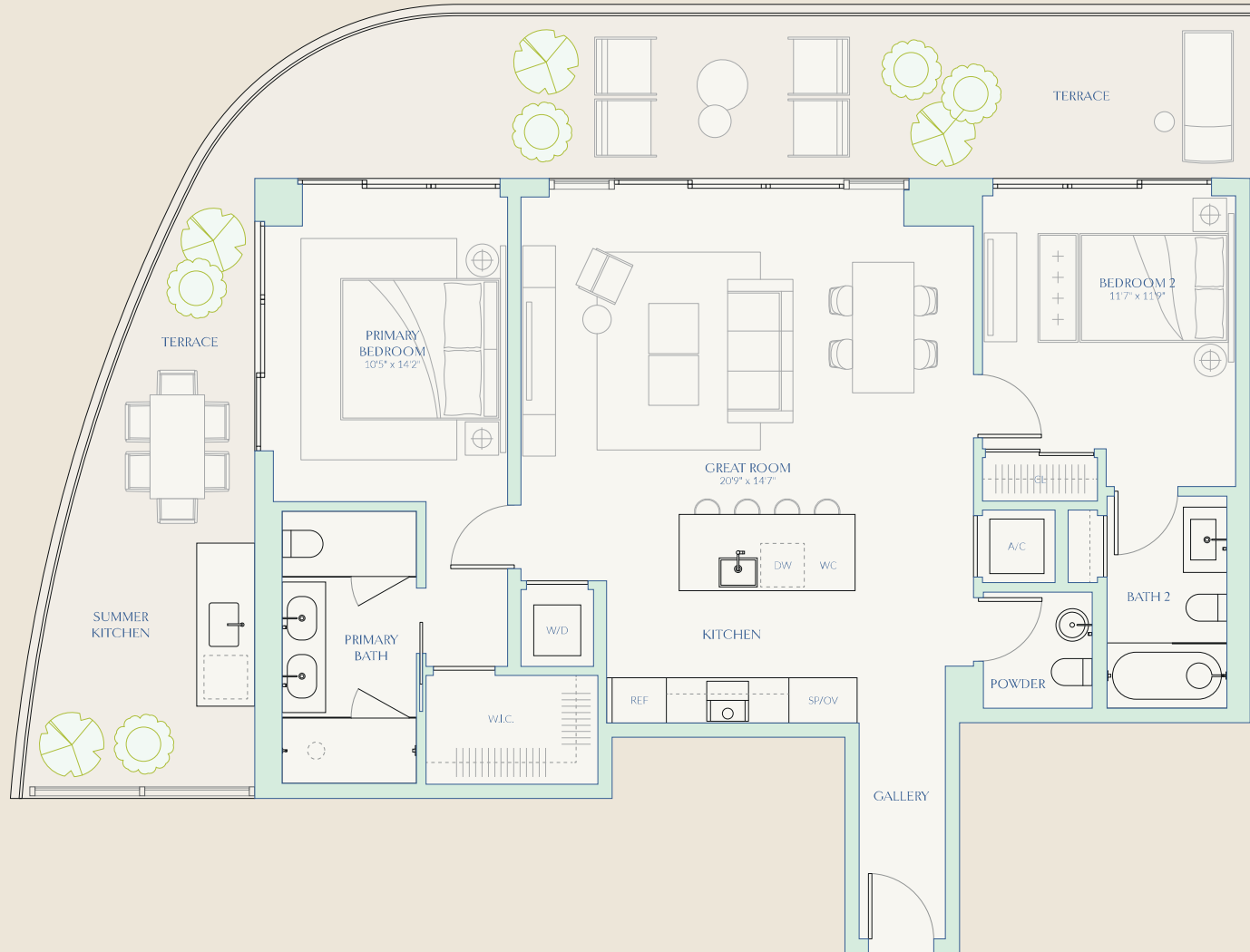

This is not intended to be an offer to sell, or solicitation to buy, condominium units to residents of any jurisdiction where prohibited by law, and your eligibility for purchase will depend upon your state of residency. The offering is made only by the prospectus for the condominium and no statement should be relied upon if not made in the prospectus. Stated interior square footage is measured to the exterior face of exterior walls and to the centerline of interior dividing walls or to the exterior face of walls adjoining corridors or other common elements or shared facilities without excluding areas that may be occupied by columns or other structural components. This method of measurement varies from, and is larger than, the dimensions that would be determined by using the description and the definition of the Unit set forth in the Declaration (which generally only includes the interior airspace between the perimeter walls and excludes structural components). For reference, the area of the unit, determined in accordance with the unit boundaries set forth in Exhibit "D" to the Declaration, is set forth in Exhibit "D" to the Declaration. All dimensions are approximate and may vary with actual construction. **ORAL REPRESENTATIONS CANNOT BE RELIED UPON AS CORRECTLY STATING THE REPRESENTATIONS OF THE DEVELOPER. FOR CORRECT REPRESENTATIONS, MAKE REFERENCE TO THIS BROCHURE AND TO THE DOCUMENTS REQUIRED BY SECTION 718.503, FLORIDA STATUTES, TO BE FURNISHED BY A DEVELOPER TO A BUYER OR LESSEE.**

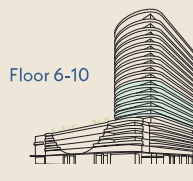

Floor 6-10

B6

TWO BEDROOMS
TWO BATHS
ONE POWDER ROOM

INTERIOR 1,354 SF | 125.8 SM
EXTERIOR 686 SF | 63.7 SM
TOTAL 2,040 SF | 189.5 SM

PARK 6
OCEAN VIEW

72
CARLYLE
MIAMI BEACH RESIDENCES
By Piero Lissoni

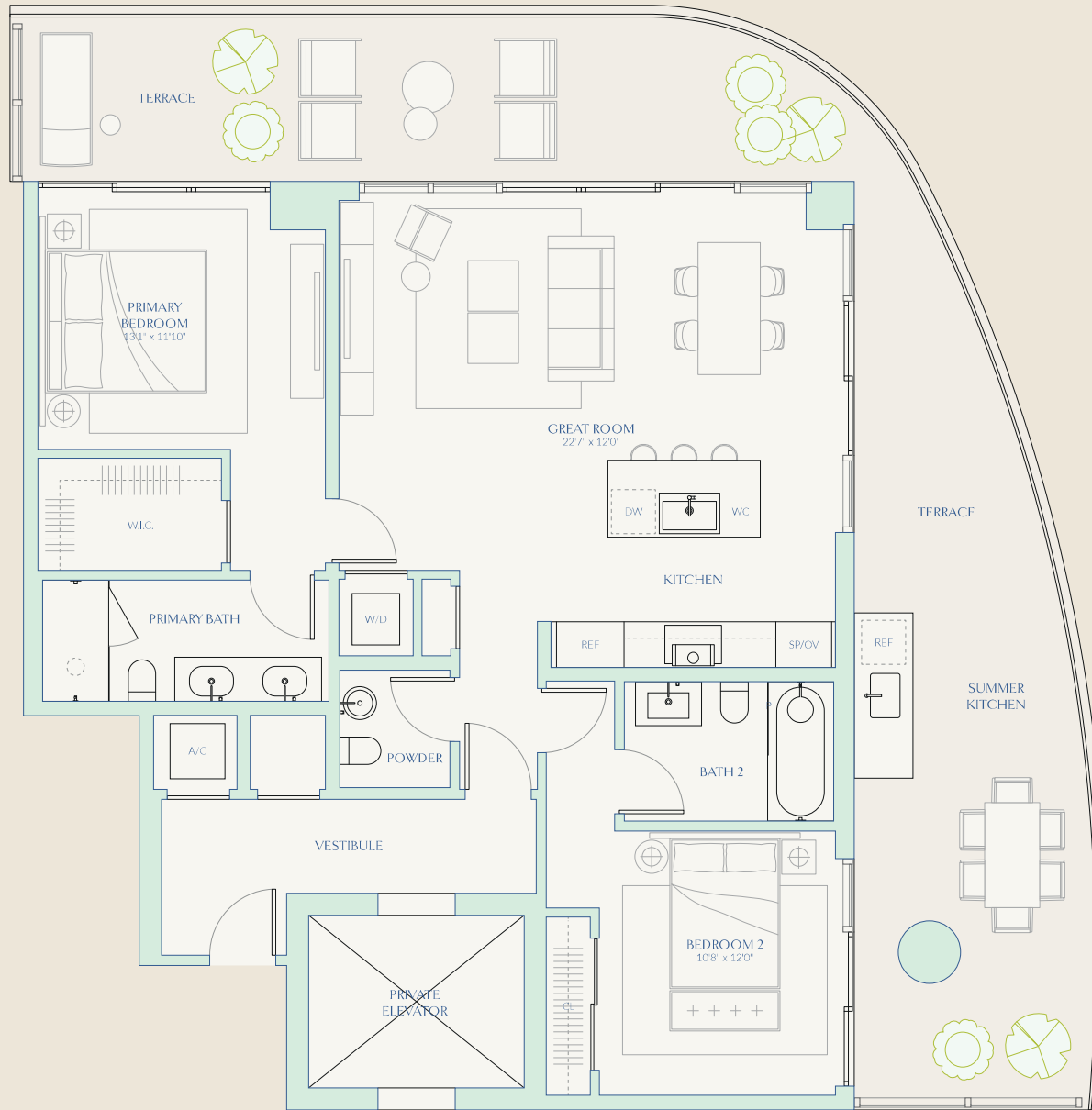

 This is not intended to be an offer to sell, or solicitation to buy, condominium units to residents of any jurisdiction where prohibited by law, and your eligibility for purchase will depend upon your state of residency. The offering is made only by the prospectus for the condominium and no statement should be relied upon if not made in the prospectus. Stated interior square footage is measured to the exterior face of exterior walls and to the centerline of interior dividing walls or to the exterior face of walls adjoining corridors or other common elements or shared facilities without including areas that may be occupied by columns or other structural components. This method of measurement varies from and is larger than the dimensions that would be determined by using the description and the definition of the Unit set forth in the Declaration (which generally only includes the interior airspace between the perimeter walls and excludes structural components). For reference, the area of the unit, determined in accordance with the unit boundaries set forth in the Declaration is set forth in Exhibit "D" to the Declaration. All dimensions are approximate and may vary with actual construction. **ORAL REPRESENTATIONS CANNOT BE RELIED UPON AS CORRECTLY STATING THE REPRESENTATIONS OF THE DEVELOPER. FOR CORRECT REPRESENTATIONS, MAKE REFERENCE TO THE BROCHURE AND TO THE DOCUMENTS REQUIRED BY SECTION 718.503, FLORIDA STATUTES, TO BE FURNISHED BY A DEVELOPER TO A BUYER OR LESSEE.**

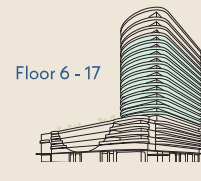

Floor 6 - 17

B10

TWO BEDROOMS
TWO BATHS
ONE POWDDER ROOM

INTERIOR 1,298 SF | 120.6 SM
EXTERIOR 377 SF | 35.0 SM
TOTAL 1,675 SF | 155.6 SM

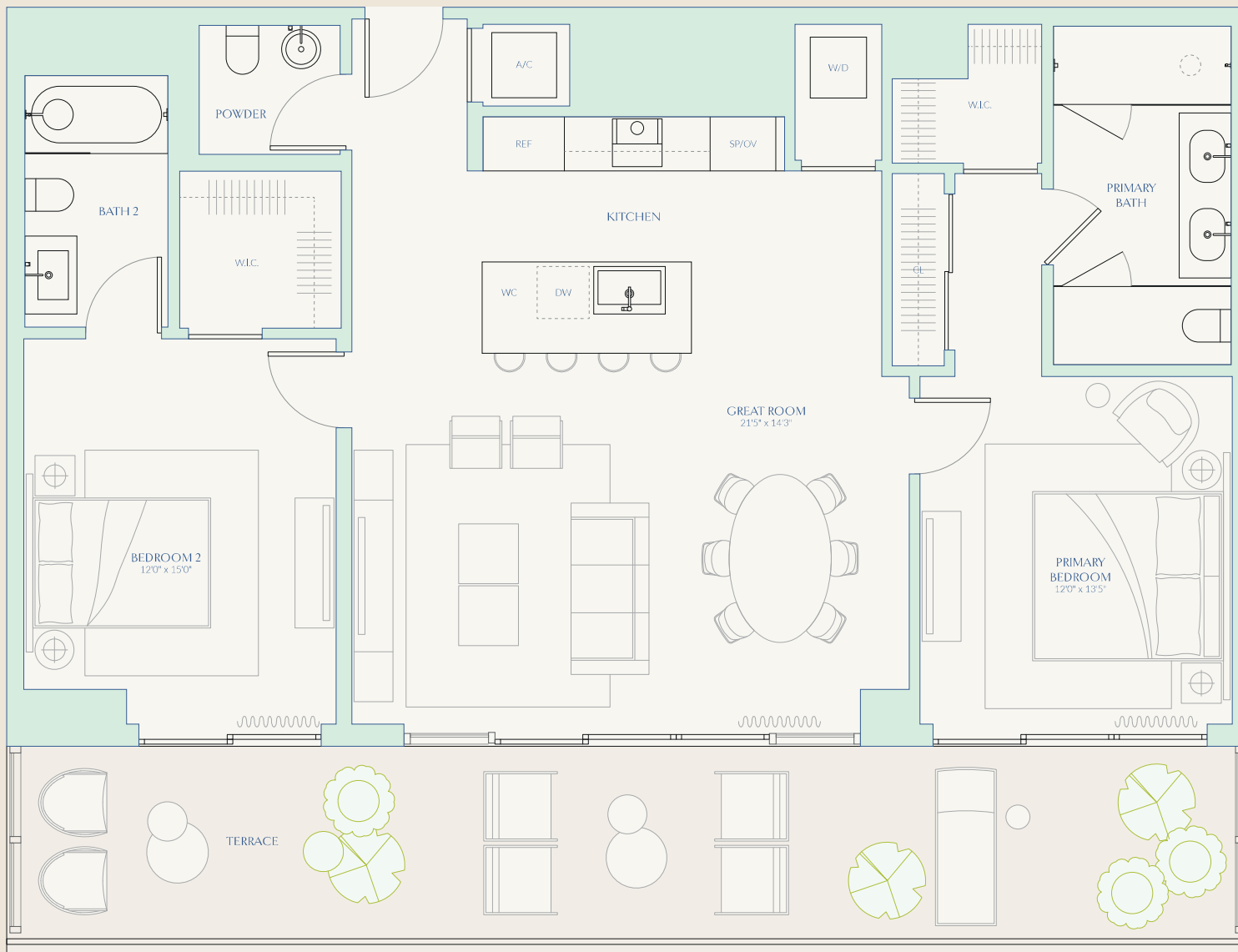

INTRACOASTAL/
BAY VIEW



This is not intended to be an offer to sell, or solicitation to buy, condominium units to residents of any jurisdiction where prohibited by law, and your eligibility for purchase will depend upon your state of residency. The offering is made only by the prospectus for the condominium and no statement should be relied upon if not made in the prospectus. Stated interior square footage is measured to the exterior face of exterior walls and to the centerline of interior dividing walls or to the exterior face of walls adjoining corridors or other common elements or shared facilities without including areas that may be occupied by columns or other structural components. This method of measurement varies from and is larger than the dimensions that would be determined by using the description and the definition of the Unit set forth in the Declaration (which generally only includes the interior airspace between the perimeter walls and includes structural components). For reference, the area of the unit, determined in accordance with the unit boundaries set forth in the Declaration is set forth in Exhibit "D" to the Declaration. All dimensions are approximate and may vary with actual construction. **ORAL REPRESENTATIONS CANNOT BE RELIED UPON AS CORRECTLY STATING THE REPRESENTATIONS OF THE DEVELOPER. FOR CORRECT REPRESENTATIONS, MAKE REFERENCE TO THIS BROCHURE AND TO THE DOCUMENTS REQUIRED BY SECTION 718.503, FLORIDA STATUTES, TO BE FURNISHED BY A DEVELOPER TO A BUYER OR LESSEE.**

NORTH
⬆

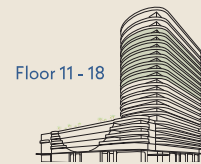

Floor 11 - 18