



## RESIDENCE A LEVEL 5 & 6

THREE BEDROOMS  
THREE BATHROOMS  
POWDER ROOM

**INTERIOR**  
2,389 SQ. FT / 222 SQ. M

**EXTERIOR**  
602 SQ. FT / 56 SQ. M

**TOTAL**  
2,991 SQ. FT / 278 SQ. M

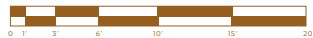
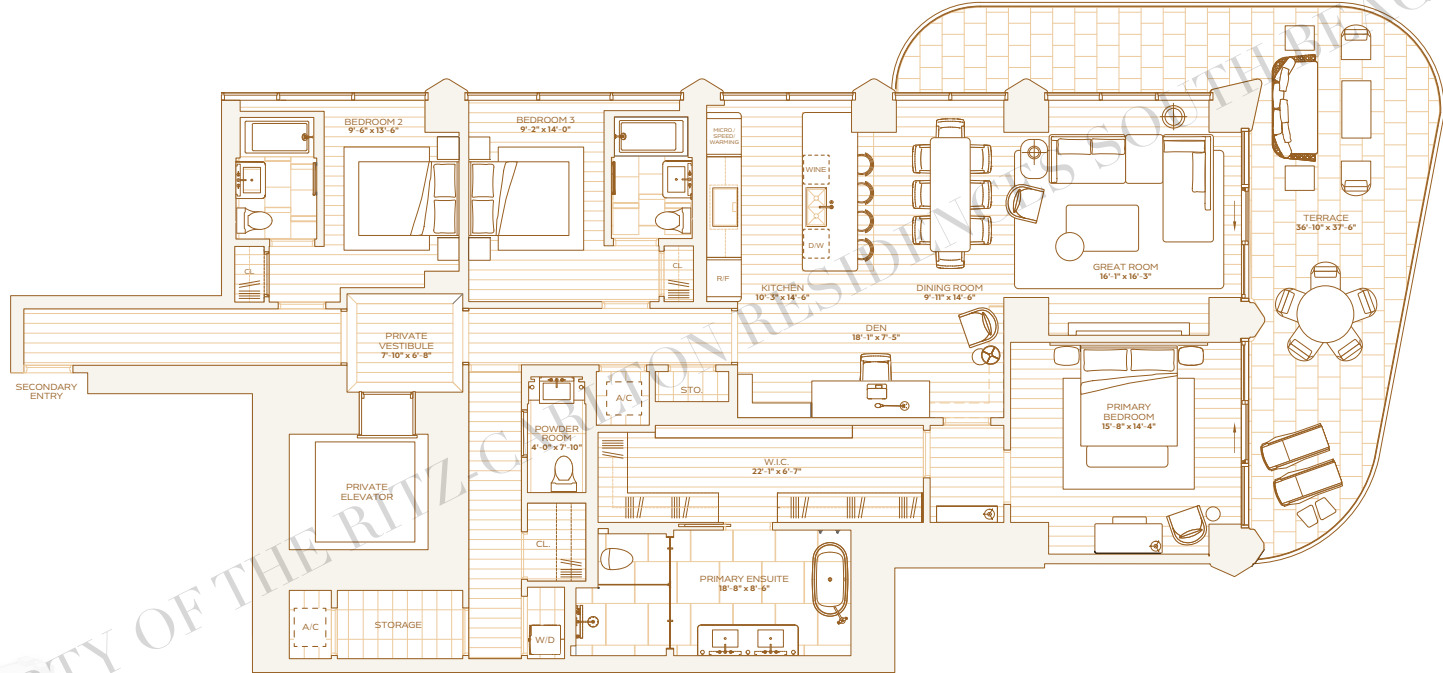



**RESIDENCE B**  
**LEVEL 9 & 10**

THREE BEDROOMS  
THREE BATHROOMS  
POWDER ROOM

**INTERIOR**  
2,247 SQ. FT. / 209 SQ. M

**EXTERIOR**  
591 SQ. FT. / 55 SQ. M

**TOTAL**  
2,838 SQ. FT. / 264 SQ. M

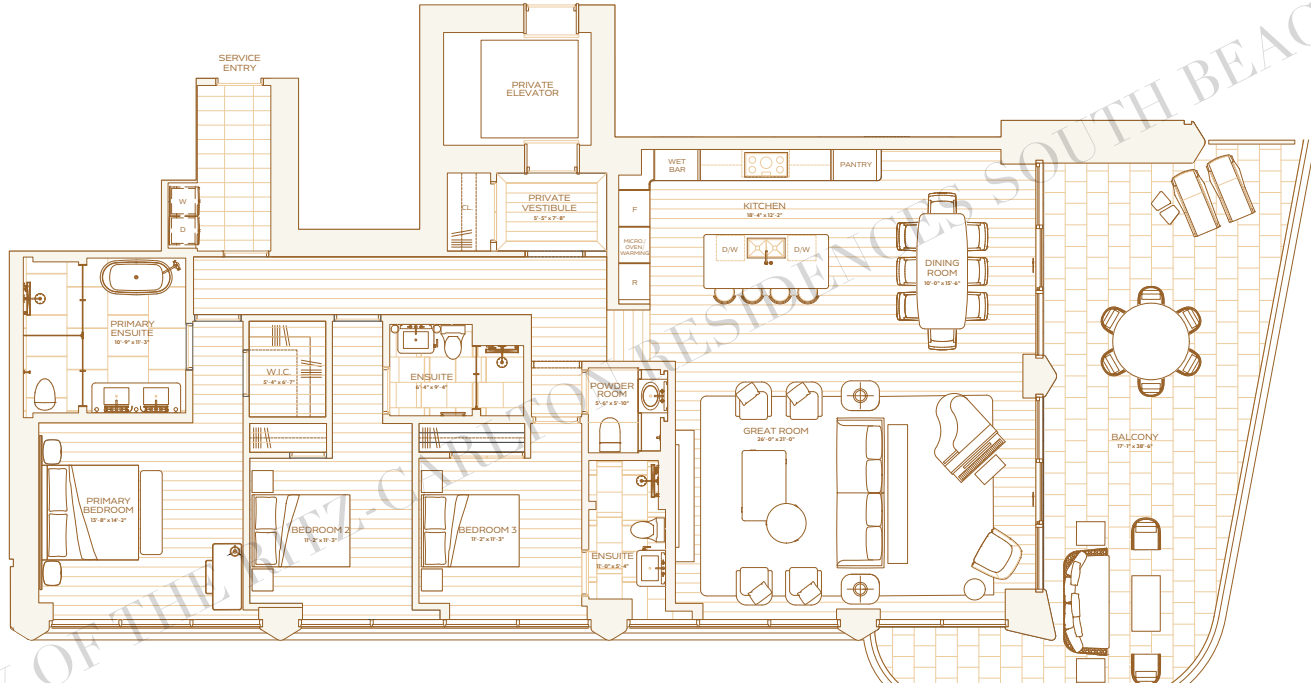



**THE RITZ-CARLTON RESIDENCES**  
SOUTH BEACH

## RESIDENCE B LEVEL 11 & 12

THREE BEDROOMS  
THREE BATHROOMS  
POWDER ROOM

**INTERIOR**  
2,991 SQ. FT. / 278 SQ. M

**EXTERIOR**  
912 SQ. FT. / 85 SQ. M

**TOTAL**  
3,903 SQ. FT. / 363 SQ. M

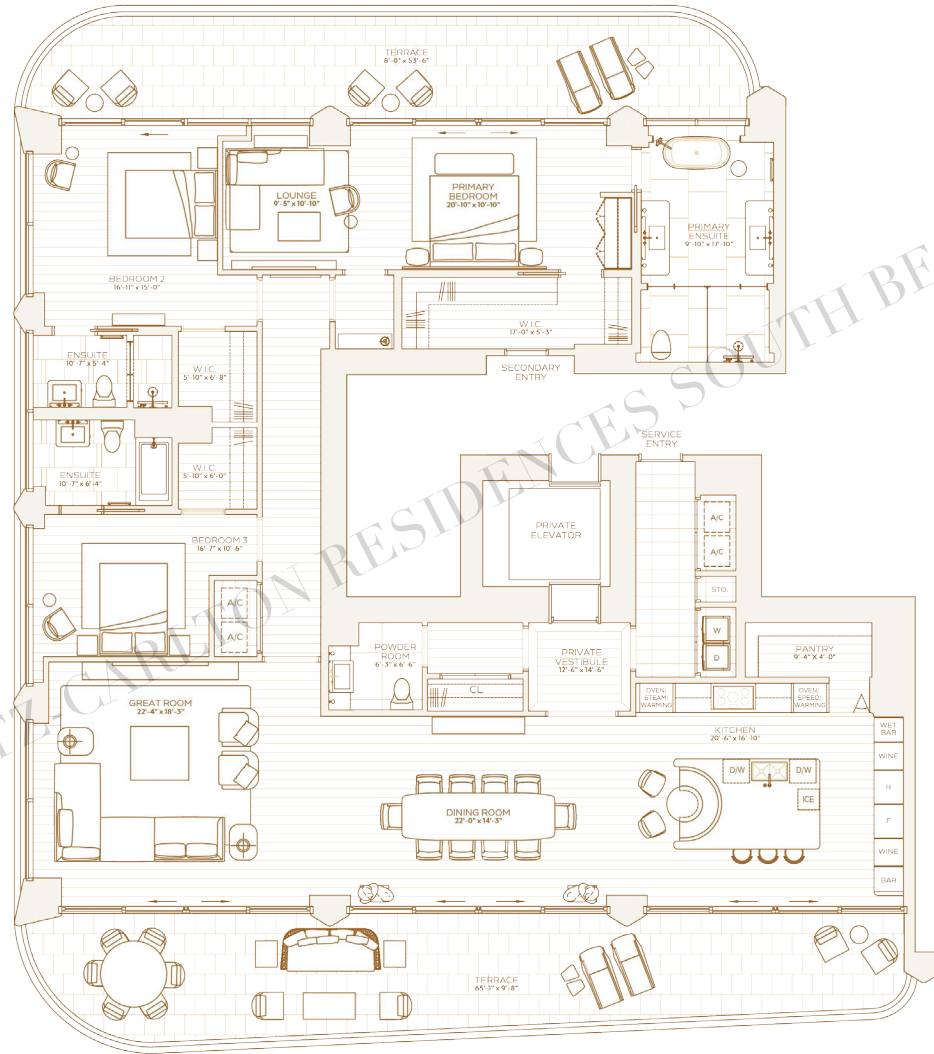

1671 COLLINS AVE.  
MIAMI BEACH, FL 33139

THE RITZ-CARLTON RESIDENCES SOUTH BEACH ARE NOT OWNED, DEVELOPED OR SOLD BY THE RITZ-CARLTON HOTEL COMPANY LLC OR ITS AFFILIATES (THE "RITZ-CARLTON"). SOME SKY DEVELOPMENT LLC IS THE RITZ-CARLTON MARKS & TRADE LICENSEE FROM THE RITZ-CARLTON, WHICH HAS NOT CONFIRMED THE ACCURACY OF ANY OF THE STATEMENTS OR REPRESENTATIONS MADE HEREIN. STATIONED INTERIOR SQUARE FOOTAGE IS MEASURED TO THE EXTERIOR FACE OF EXTERIOR WALLS AND TO THE CENTERLINE OF INTERIOR DIVIDING WALLS (UP TO THE EXTERIOR FACE OF WALLS ADJOINING CORRIDORS OR OTHER COMMON ELEMENTS OR SHARED FACILITIES WITHOUT EXCLUDING AREAS THAT MAY BE OCCUPIED BY COLUMNS OR OTHER STRUCTURAL COMPONENTS). THE METHOD OF MEASUREMENT VARIES FROM A C/S LARGER THAN THE DIMENSIONS THAT WOULD BE DETERMINED BY JOINING THE CENTERLINE OF THE UNIT SET POINT TO THE DECLARATION, WHICH GENERALLY INCLUDES THE INTERMEDIATE BETWEEN THE INTERIOR WALLS AND EXTERIOR WALLS. THE AREA OF THE UNIT DETERMINED ACCORDING TO THE UNIT BOUNDARIES SET FORTH IN THE DECLARATION IS APPROXIMATE AND MAY VARY WITH ACTUAL CONSTRUCTION. NOTE THAT MEASUREMENTS OF ROOMS SET FORTH ON THE FLOOR PLAN ARE GENERALLY TAKEN AT THE GREATEST POINTS OF EACH ROOM. ROOMS ARE NOT REPRESENTED AS RECTANGLES WITHOUT RESPECT TO ANY CURVED OR IRREGULAR PARTS. OCCASIONALLY, THE AREA OF THE ACTUAL ROOM WILL TYPICALLY BE SMALLER THAN THE PRODUCT OBTAINED BY ALL THE DIMENSIONS LISTED. THE FLOOR PLAN IS A CONCEPTUAL REPRESENTATION AND IS SUBJECT TO CHANGE. THE DEVELOPER RESERVES THE RIGHT TO MAKE MODIFICATIONS, REVISIONS, AND CHANGES IN ITS SOLE AND ABSOLUTE DISCRETION. ALL DEPICTIONS OF PLUMBING, APPLIANCES, BUILT-IN COUNTERTOPS, SOFFITS, FLOORCOVERINGS, LIGHT FIXTURES, LANDSCAPING AND OTHER MATTERS OF DETAIL, INCLUDING, WITHOUT LIMITATION, ITEMS OF FINISH AND DECORATION, ARE CONCEPTUAL ONLY AND ARE NOT NECESSARILY INCLUDED IN EACH UNIT. CONSULT YOUR ARCHITECT AND PURCHASE AGREEMENT.

