



THE RITZ-CARLTON RESIDENCES

WEST PALM BEACH

Residence B3

2 Bedrooms
2 Bathrooms
1 Powder Room

INTERIOR
1,939 SF

EXTERIOR
188.5 SF

TOTAL AREA
2,127.5 SF

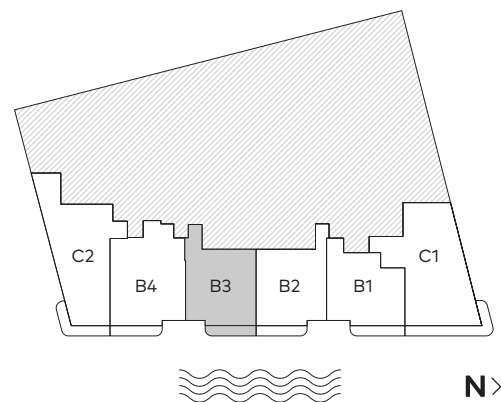

1717 N Flagler Drive West Palm Beach, FL 33407



There are various methods for calculating the square footage of a Unit and depending on the method of calculation, the quoted square footage of a Unit in advertising materials may vary from the square footage of a Unit as described in the Prospectus and the Declaration. The dimensions of the Unit shown have been calculated from the exterior boundaries of the exterior walls to the centerline of interior demising walls, including common elements such as structural walls and other interior structural components of the building which method results in a calculation of square footage greater than if measured in other customary methods, such as from finished painted surface to finished painted surface as an example. All dimensions are approximate and may vary with actual construction. All floor plans are subject to change. The furnishings and décor illustrated are not placed in a manner intended to guaranty a particular use of the space and are not included with the purchase of the Unit. Consult the Developer's Prospectus for information regarding terms, conditions, the calculation of the Unit dimensions and to learn what is included with purchase. Marriott International, Inc. The Related Group, and BH Group are Licensors of the Developer. 1717 N Flagler Drive Venture, LLC Ritz-Carlton® is the registered mark of Marriott International, Inc. 2024© 1717 N Flagler Drive Venture, LLC. ®