

OCEANFRONT

# Residences 902 & 1002

4 Bedroom | 6.5 Bathroom  
with Den & Service Quarters

## Residence 902

UNIT	5,613 SF
BALCONY	1,166 SF
ROOFTOP	2,439 SF
TOTAL	9,218 SF

## Residence 1002

UNIT	5,613 SF
BALCONY	1,166 SF
ROOFTOP	4,840 SF
TOTAL	11,619 SF

*Intimate Oceanfront Living*

### A Rosewood Residence

DEVELOPERS  
The Related Group & Dezer Development

ARCHITECT  
Arquitectonica

INTERIOR DESIGNER  
Studio Piet Boon

1180 Hillsboro Mile  
Hillsboro Beach, Florida 33062

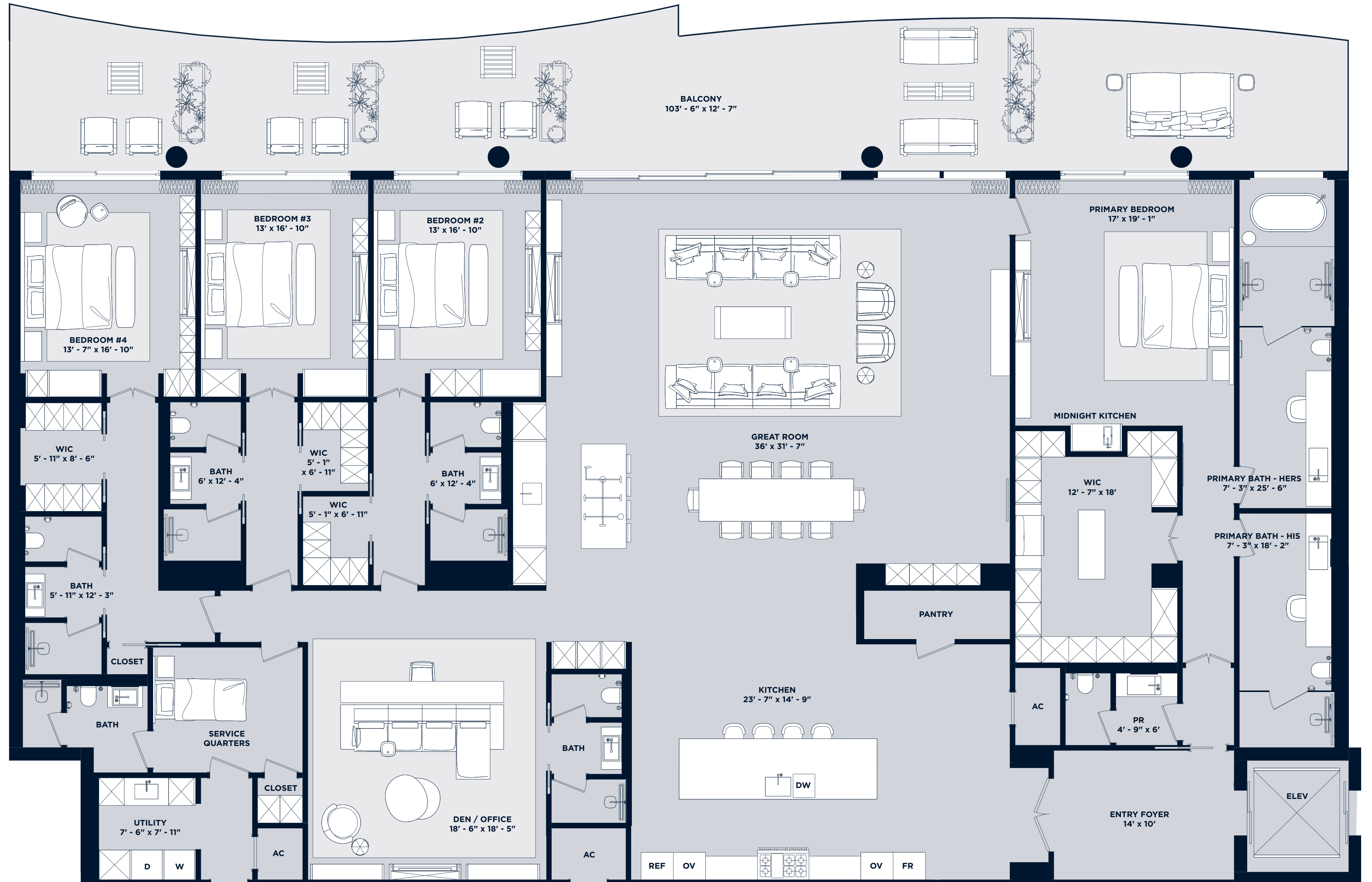

The dimensions stated for this floor plan are approximate because there are various recognized methods for calculating the square footage of a unit. The square footage stated here is calculated from the exterior boundaries of the exterior walls to the centerline of interior opening walls without deductions for closets, curves, or architectural features. This method typically results in quoted dimensions greater than the dimensions that would be determined by using other accepted methods. The definition of "lineal" and the calculation method to be relied upon is set forth by the Developer in Developer's prospectus which method may result in a square footage calculation less than the result of the calculation method used here. Renderings depict features not included with purchase, but which are available at an additional cost such as wine bar and closet millwork among others. Consult the Developer's prospectus to learn what is included with Unit purchase and to understand Unit dimensions. 2023 © HILLSBORO MILE PROPERTY OWNERS, LLC with all rights reserved.

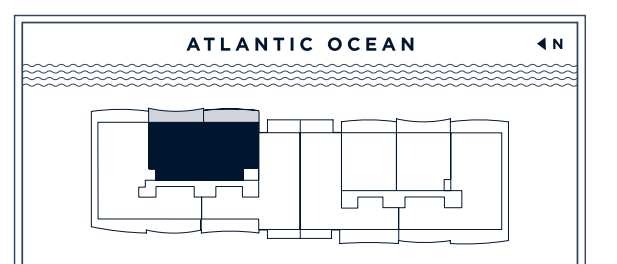

OCEANFRONT

# Residences 907 & 1007

4 Bedroom | 6.5 Bathroom  
with Den & Service Quarters

## Residence 907

UNIT	5,613 SF
BALCONY	1,150 SF
ROOFTOP	2,395 SF
TOTAL	9,158 SF

## Residence 1007

UNIT	5,613 SF
BALCONY	1,150 SF
ROOFTOP	4,430 SF
TOTAL	11,193 SF

*Intimate Oceanfront Living*

### A Rosewood Residence

DEVELOPERS  
The Related Group & Dezer Development

ARCHITECT  
Arquitectonica

INTERIOR DESIGNER  
Studio Piet Boon

1180 Hillsboro Mile  
Hillsboro Beach, Florida 33062

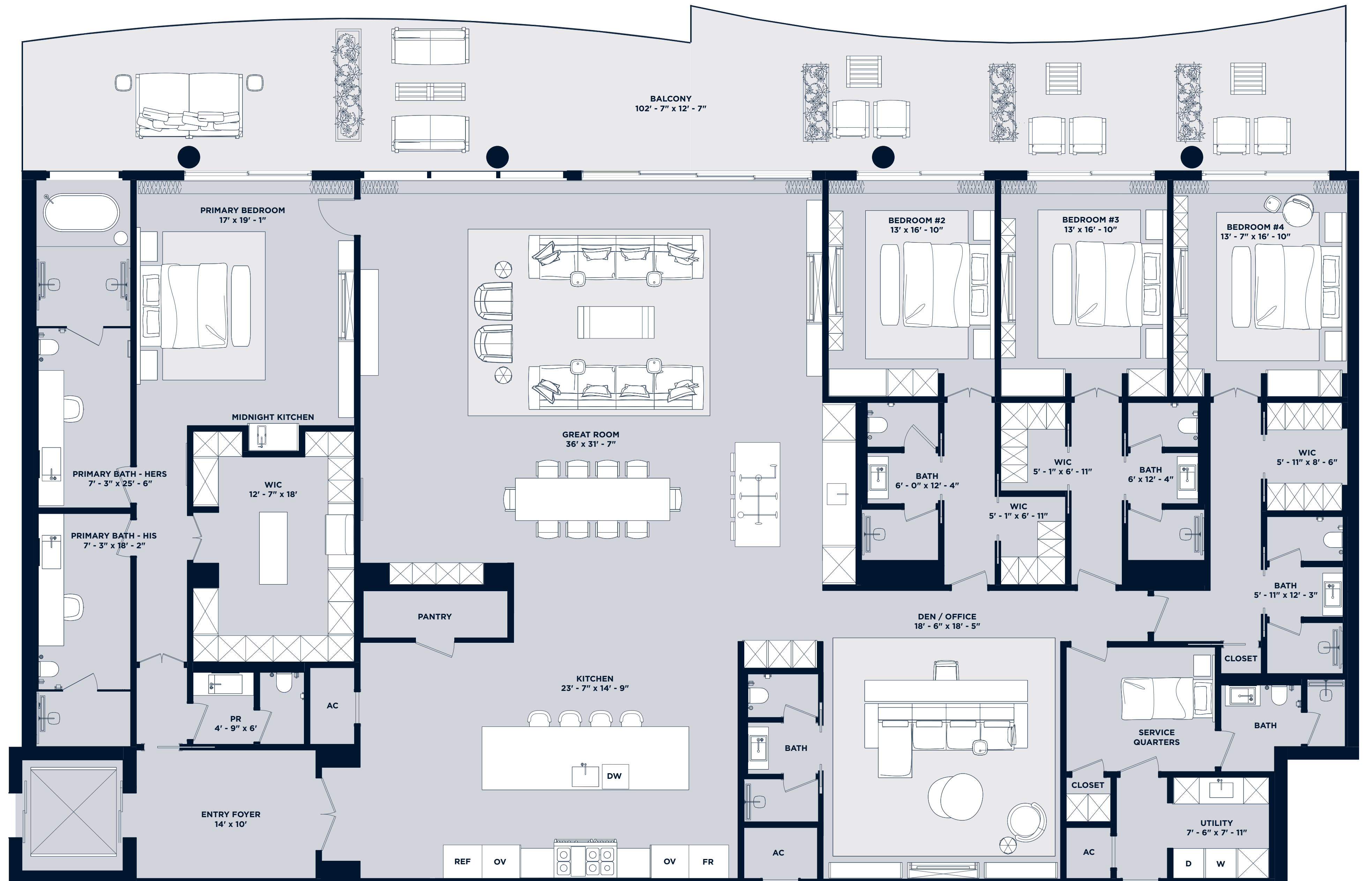

The dimensions stated for this floor plan are approximate because there are various recognized methods for calculating the square footage of a unit. The square footage stated here is calculated from the exterior boundaries of the exterior walls to the centerline of interior opening walls without deductions for columns, curves, or architectural features. This method typically results in quoted dimensions greater than the dimensions that would be determined by using other accepted methods. The definition of "unit" and the calculation method to be relied upon is set forth by the Developer in Developer's prospectus which method may result in a square footage calculation less than the result of the calculation method used here. Renderings depict features not included with purchase, but which are available at an additional cost such as wine bar and closet millwork among others. Consult the Developer's prospectus to learn what is included with Unit purchase and to understand Unit dimensions. 2023 © HILLSBORO MILE PROPERTY OWNERS, LLC with all rights reserved.